

Notepad Button Description

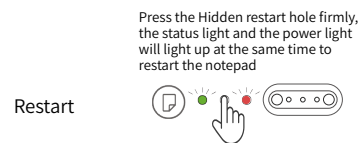
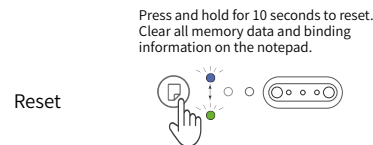
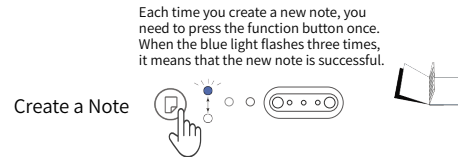
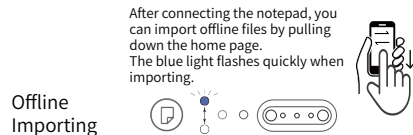
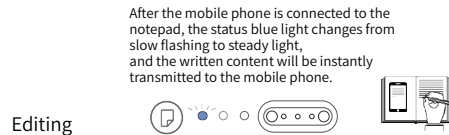
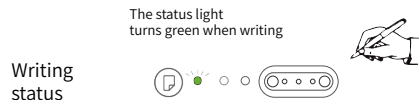
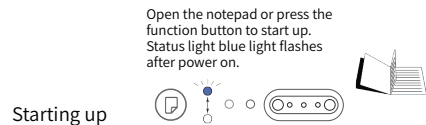
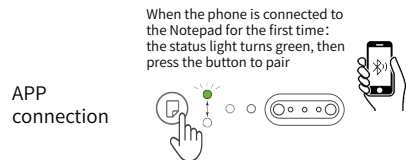
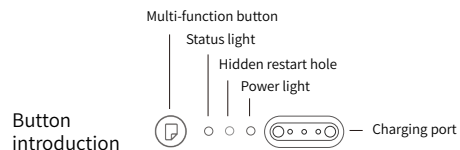

*The notepad can be restarted when it crashes. This operation will not delete the data on the notepad.

36Notes Smart Notepad

Instruction Manual



(The pen can be fixed at the spine)



Please scan the QR code to download and install 36notes apps before using this device, or search it in the App store/Google play.

Instruction Manual

Thank you for purchasing the 36 smart notebook. This User's Guide is designed to help you familiarize with all the features of this device. Please read this instruction manual carefully.

Product Information

Product number:36notes-A1

Executive standard:GB/T 30263-2013

Electromagnetic pen size: length 153mm, diameter 10.3mm

Cover material: high quality pressure change PU

Connection method: Bluetooth 5.0

Device offline memory: 16MB

Battery capacity: 1000mAh

Product weight: about 490g

Product size: 245 × 176 × 15mm

Charge:5V/0.5A

Storage and use

- ※ Avoid using this product under other products with electromagnetic fields (safe distance 10cm)
- ※ Avoid putting or using this product under Extreme temperature
- ※ Avoid putting or using this product under wet environment
- ※ Avoid exposing this product to dust and soot environment
- ※ Avoid beating or knocking on this product
- ※ Please store safely and avoid impact damage during transportation
- ※ Avoid scratching this product with sharp objects

Maintenance

- ※ Unplug all cables before cleaning the device
- ※ Please wipe the device with a soft cloth.

Charging instruction

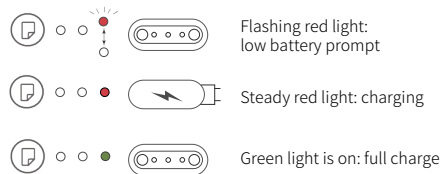

※ High temperature warning: When the temperature exceeds 45 °C, it may cause abnormal charging

Customer service hotline

Tel: 400-1639798

Email: service@36notes.com

You can contact us for technical support or other services in the above two ways.

Safe

To ensure the safety of you and others, please read the safety instructions carefully before use. Please do not disassemble 36 smart handwritings yourself, as it may bring you danger and the warranty card will be void after disassembly.

Disposal

Please ensure that the disposal of this product and accessories complies with WEEE (Waste Electrical and Electronic Equipment) regulations and other relevant policies in your country. Please pay attention to the regulations of the environmental agencies and other relevant departments on disposal regulations.

Packaging accessories

Smart Tablet *1 Passive Electromagnetic Pen*1 Manual*1
Charging Cable *1 Notebook *1 Spare Refill*1 Pencil Reader*1



※Refill replacement method



※No need to charge and adapt, you can use it when you turn it on.

※In order to sense the pressure value transmitted from the pen tip during writing, the pen tip will slightly retract when writing, which is normal.

※The ink in the refill will solidify in a low temperature environment, and it needs to be restored to normal temperature before it can be used normally.



※The charging cable is a dedicated magnetic charging cable that we independently developed. If you accidentally lose it, please go to the official website to buy it.

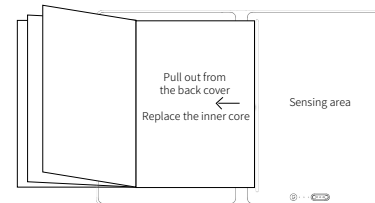

※The paper is replaceable and compatible with ordinary A5 paper; the right side is the sensing area, and writing outside the area will not be recorded.

Connection and pairing

This product needs to be used with 36notes app, after downloading 36notes app, you need to search for the notepad to connect in the app. Please ensure that the Bluetooth service and location service are turned on when searching, and give 36 corresponding APP permissions.

The first connection requires a button pairing operation, and the function button can be pressed after the green light flashes.

After logging in to the account, you can bind the device and make an automatic connection without having to press the button every time.

Each notepad can only be bound by one account. If other notepads need to be connected, the bound account should be untied or reset.